

Fit SECTION 1 into the wall cavity. Level the opening Head and Style (and Door) and fix both jamb styles temporarily.

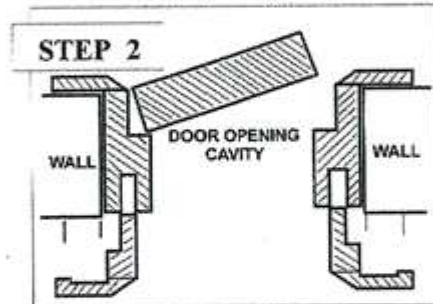

Fit SECTION 2 into the groove in the back of SECTION 1 and fix temporarily.

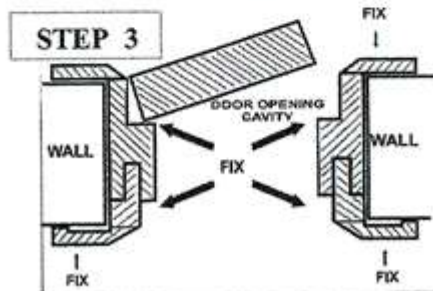

Check that the Door is both opening and closing properly and is balanced. Once complete, fix permanently.

DIAGRAMS NOT TO SCALE